

Items Supplied >

- 1 - Sissy Bar w/Pad
- 2 - Side Brackets
- 4 - Spacers
- 2 - Short M8 x 50mm Button Head Screws
- 2 - Long M8 x 55mm Button Head Screws
- 4 - 8mm x 20mm Button Head Screws

Application(s) >

Yamaha Raider 2008-2014

Instruction Manual >

02-7765 / 02-8765

Page 1 of 1

Read all instructions carefully before installing your new Cobra product!

Your sissy bar will install in just a few minutes using common tools. Read all instructions carefully and completely before installing your new sissy bar.

1. Remove and discard the (2) M8 screws from the left side fender rail. Install left sissy bar mounting bracket (*part # should face inward*) by inserting the supplied M8 x 55 mm screw through the front hole of the sissy bar mount bracket, supplied spacer, and into the front fender rail. Insert the supplied M8 x 50 mm screw through the rear hole of the sissy bar mount bracket, supplied spacer and into the fender rail (**Do Not Tighten**). Repeat procedure on right side.
2. Install the sissy bar between the brackets using the four (4) supplied 8mm x 20mm button head screws.
3. Align sissy bar and tighten all hardware. Torque all bolts to their appropriate values.

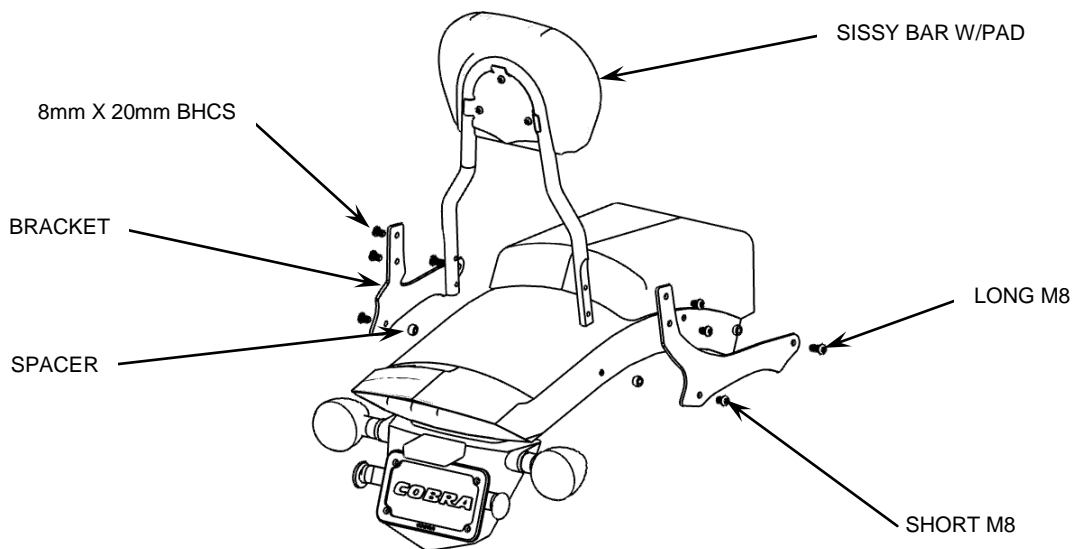

*** Cobra® recommends you always wear a helmet while riding. Please never operate your motorcycle while under the influence of alcohol and/or drugs. Enjoy the new look of your motorcycle and please ride safely.**

DOCUMENT NO. 0017 REV. B
11/08

Anything's Possible®