

BAKER CD6 MAINDRIVE GEAR & BEARING SERVICE KIT**TOOL INSTALLATION & USAGE INSTRUCTIONS****FITMENT** (for P/N TOOLA-07)

- 2006-2009 Dyna[®], Stock Cruise Drive 6 Speed (CD6) Gearset
- 2007-2009 Softail[®], Stock Cruise Drive 6 Speed (CD6) Gearset
- 2007-2009 Touring, Stock Cruise Drive 6 Speed (CD6) Gearset
- BAKER DD7 Gearset

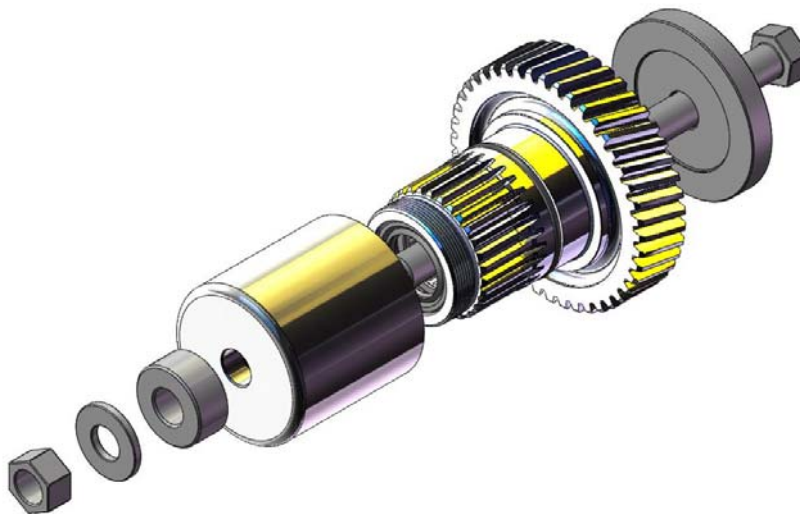

BAKER CD6 MAINDRIVE GEAR & BEARING SERVICE KIT

TABLE OF CONTENTS

- 2) Table Of Contents
- 3) Main Drive Gear Installation And Removal Tools
- 4) Main Drive Gear Bearing Installation And Removal Tools
- 5) Main Drive Gear Removal
- 6) Main Drive Gear Installation
- 7) Main Drive Gear Bearing Removal
- 6) Main Drive Gear Bearing Installation
- 9) Terms
- 10) Disclaimer

BAKER CD6 MAINDRIVE GEAR & BEARING SERVICE KIT

MAIN DRIVE GEAR INSTALLATION & REMOVAL TOOLS

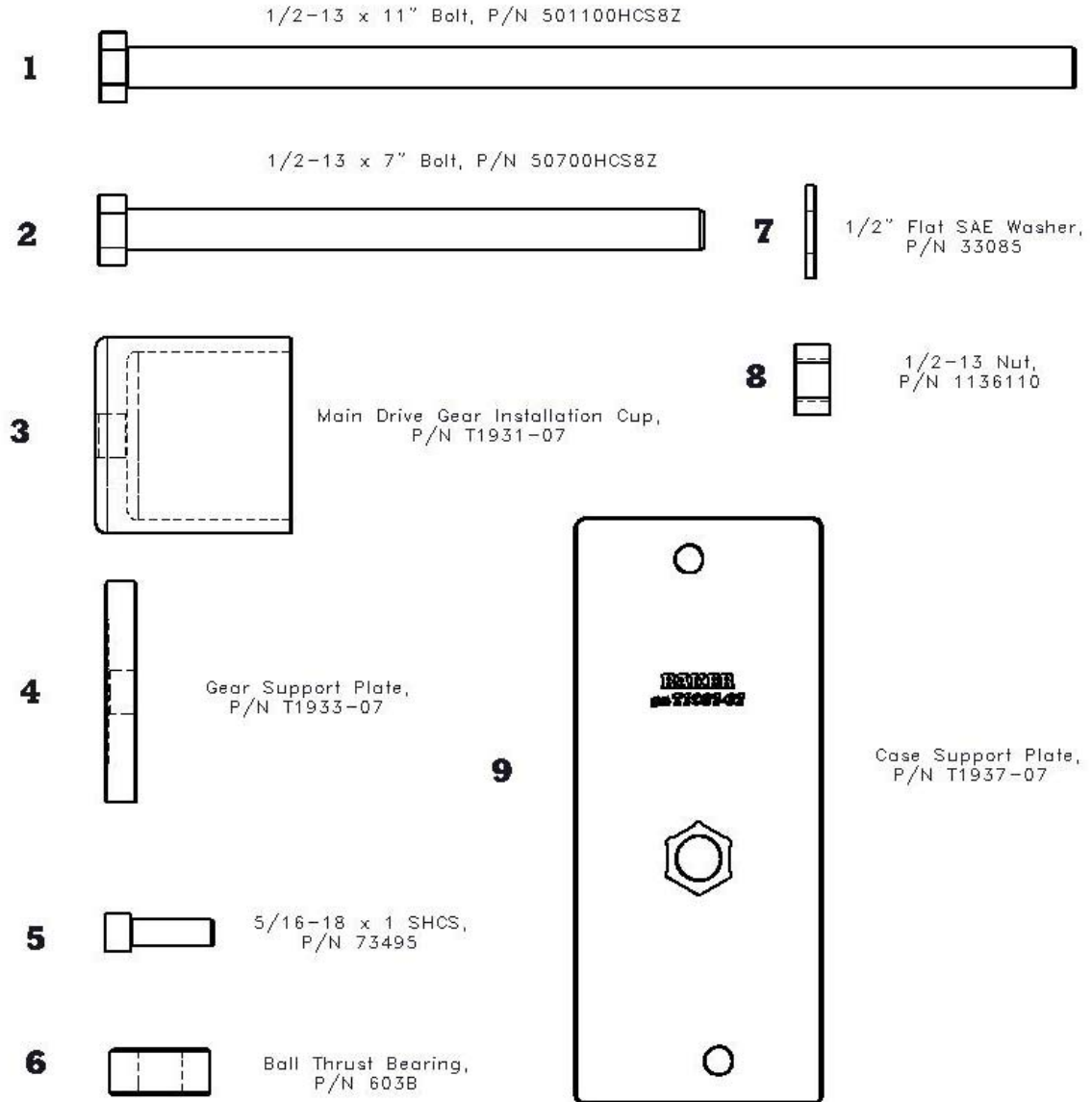

Figure 1

BAKER CD6 MAINDRIVE GEAR & BEARING SERVICE KIT

MAIN DRIVE GEAR BEARING INSTALLATION & REMOVAL TOOLS

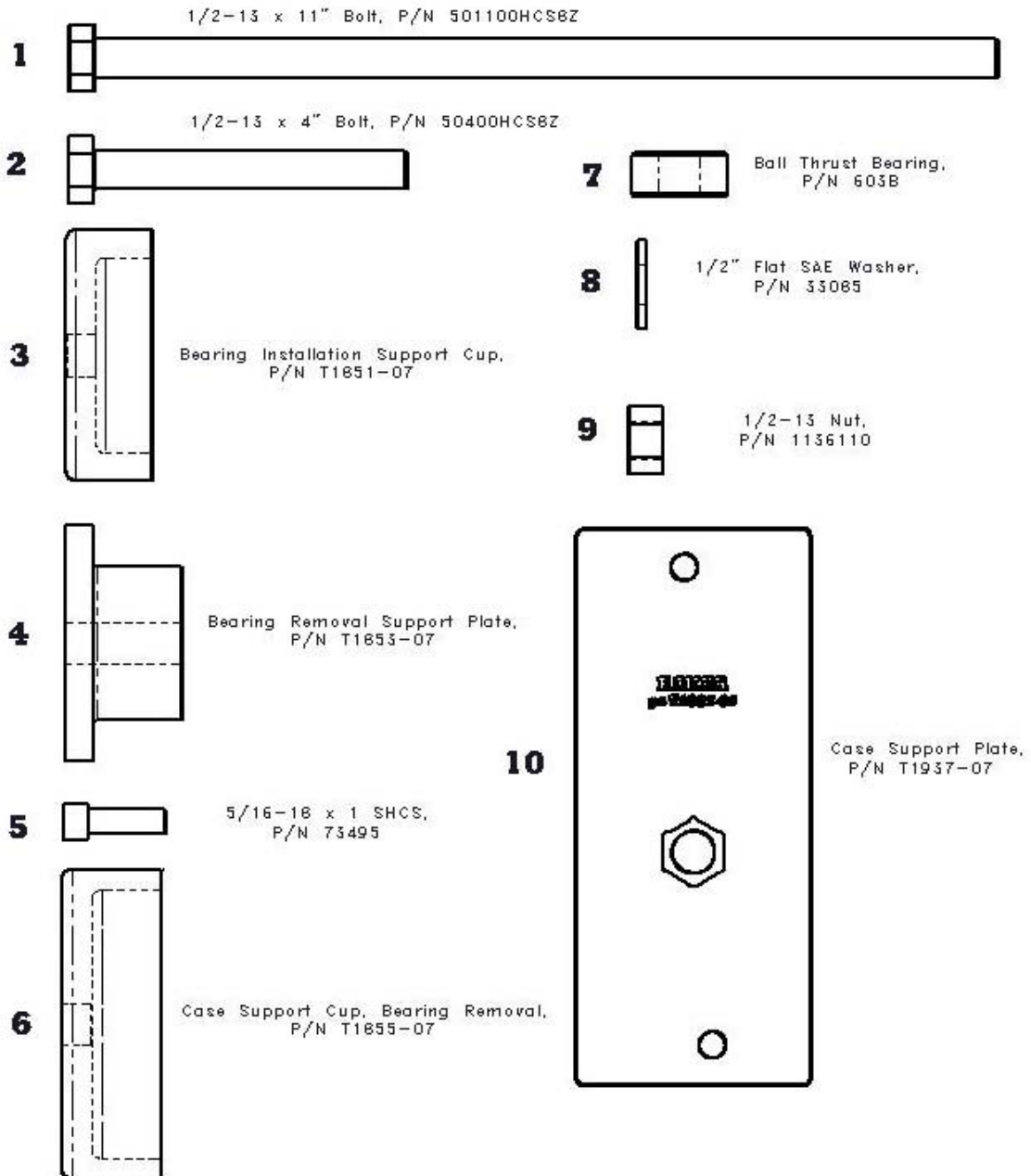

Figure 2

BAKER CD6 MAINDRIVE GEAR & BEARING SERVICE KIT

MAIN DRIVE GEAR REMOVAL

1) Install the main drive gear removal tools in the sequence shown. Take care not to 'skip' the threads of the draw bar (1) across the seal in the end of the main drive gear. Orient the support plate (4) with the .030" deep counter bore facing the main drive gear.

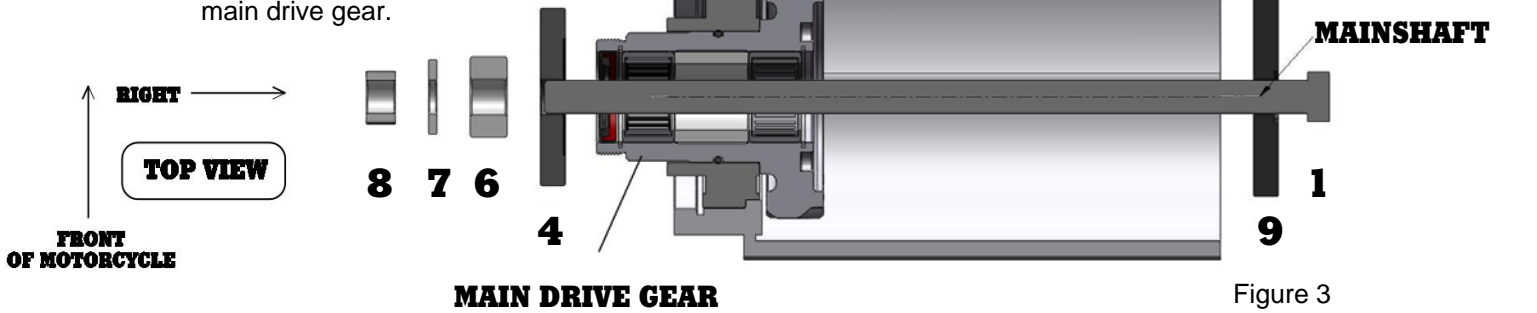

Figure 3

2) Secure the case support plate (9) to the right side using the provided 5/16-18 socket head cap screws. Tighten the nut on the draw bar by hand. Make sure the counter bore of the gear support plate (4) fits over the end of the main drive gear.

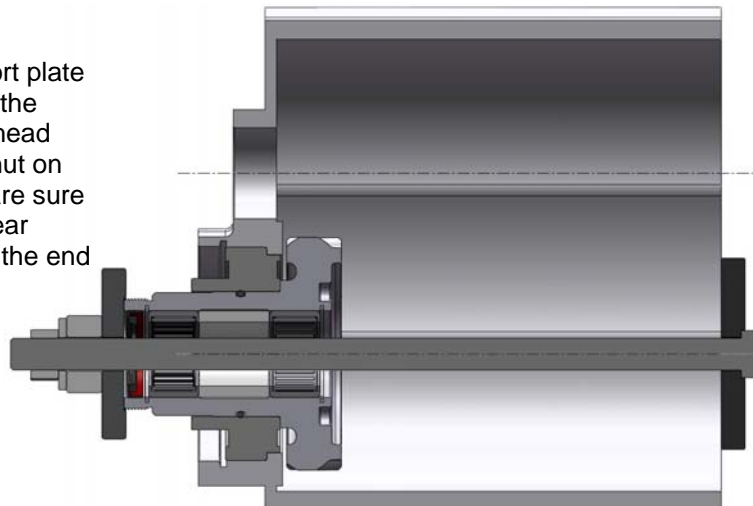

Figure 4

3) Tighten the nut on the draw bar with a 3/4" wrench until the gear 'drops' out of the bearing.

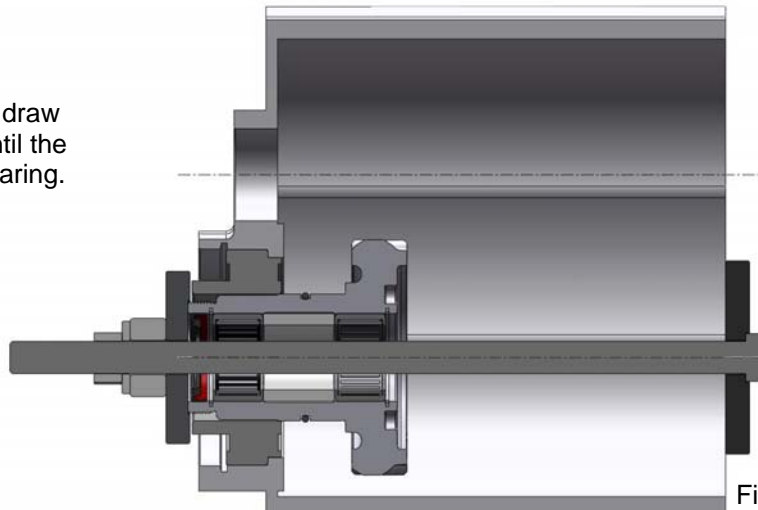

Figure 5

BAKER CD6 MAINDRIVE GEAR & BEARING SERVICE KIT

MAIN DRIVE GEAR INSTALLATION

1) Install the main drive gear removal tools in the sequence shown. Take care not to 'skip' the threads of the draw bar (2) across the seal in the end of the main drive gear.

RIGHT →
 ↑
TOP VIEW
 FRONT OF MOTORCYCLE

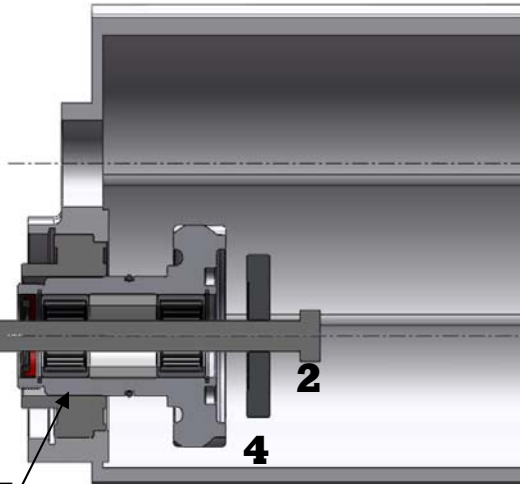
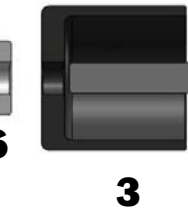
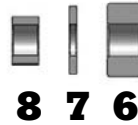

COUNTERSHAFT

MAINSHAFT

MAIN DRIVE GEAR BEARING

Figure 6

2) Tighten the nut on the draw bar by hand. Make sure the gear support plate (4) fits into the counter bore on the right side of the gear.

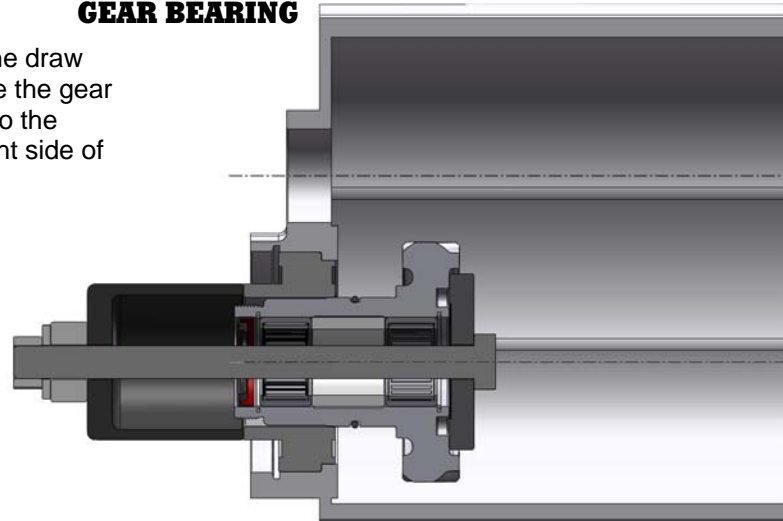

Figure 7

3) Tighten the nut on the draw bar with a 3/4" wrench until the gear is fully seated against the bearing.

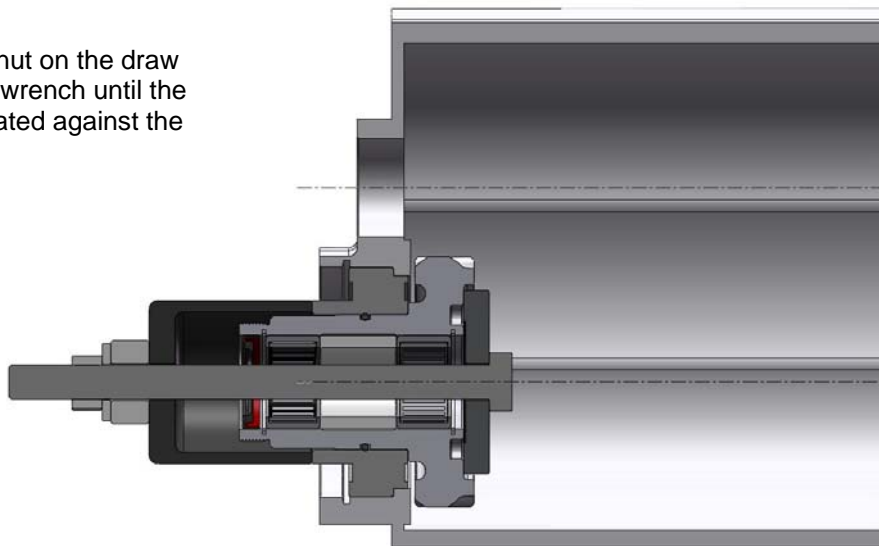
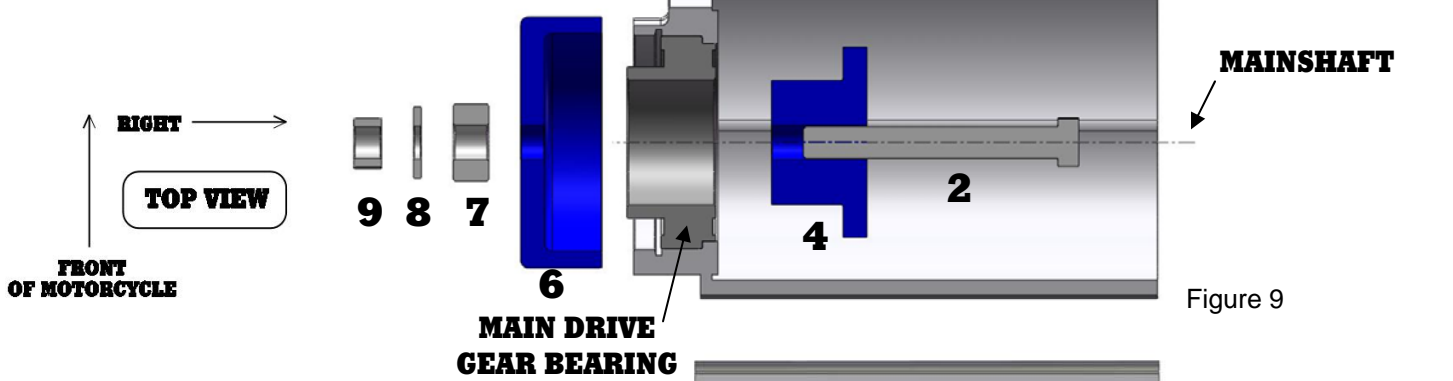

Figure 8

BAKER CD6 MAINDRIVE GEAR & BEARING SERVICE KIT

MAIN DRIVE GEAR BEARING REMOVAL

1) Install the main drive gear bearing removal tools in the sequence shown



2) Tighten the nut on the draw bar by hand

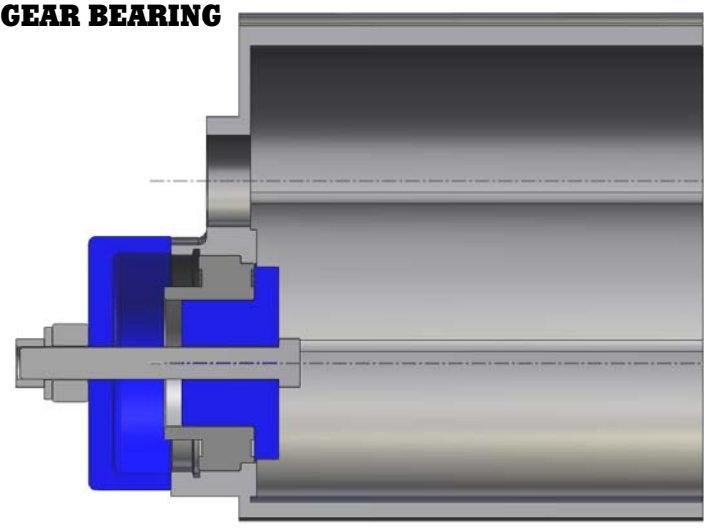

3) Tighten the nut on the draw bar with a 3/4" wrench until the bearing 'drops' out the case

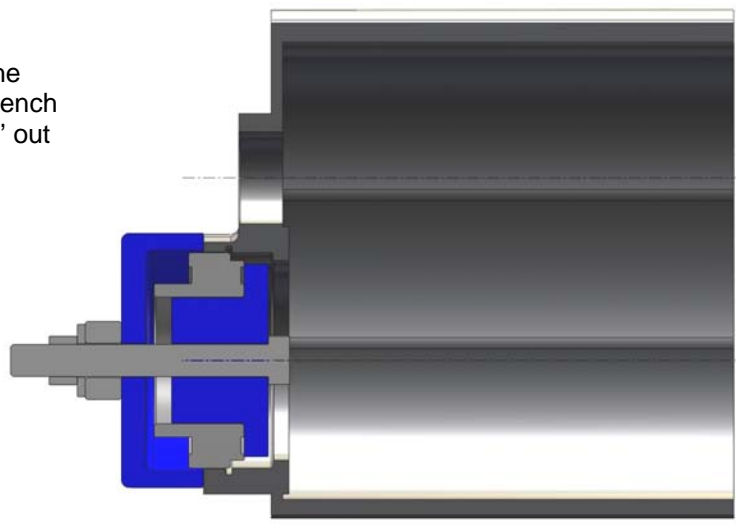

BAKER CD6 MAINDRIVE GEAR & BEARING SERVICE KIT

MAIN DRIVE GEAR BEARING INSTALLATION

1) Install the main drive gear bearing installation tools in the sequence shown.

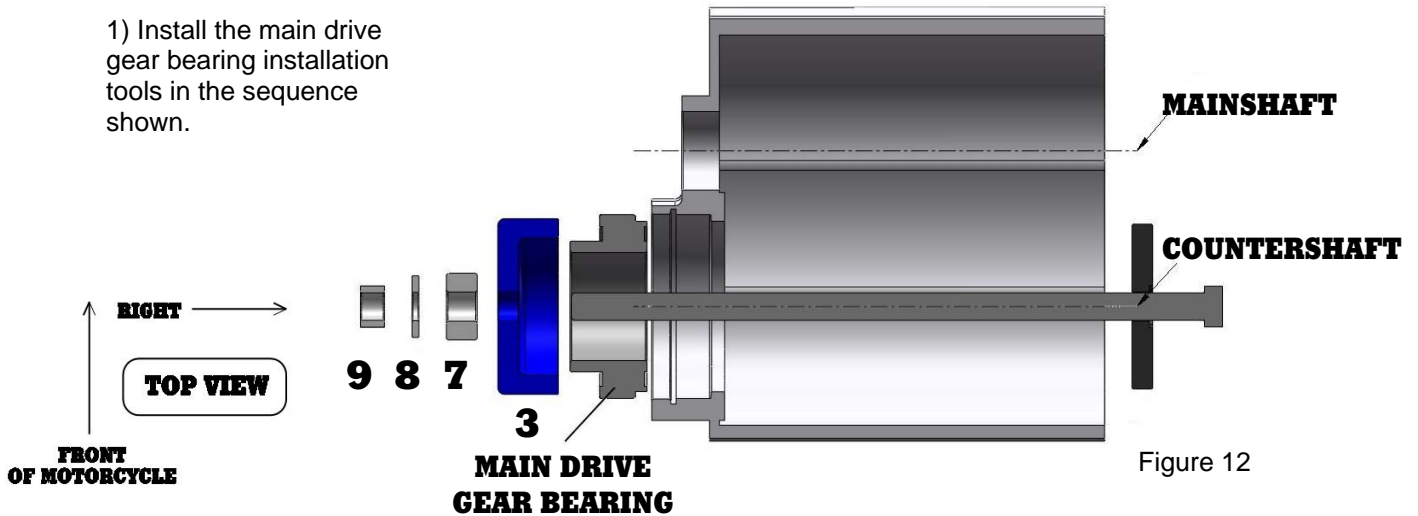

Figure 12

2) Secure the case support to Case with 'BAKER' Logo facing outward using the provided 5/16-18 socket head cap screws. Tighten the nut on the draw bar by hand.

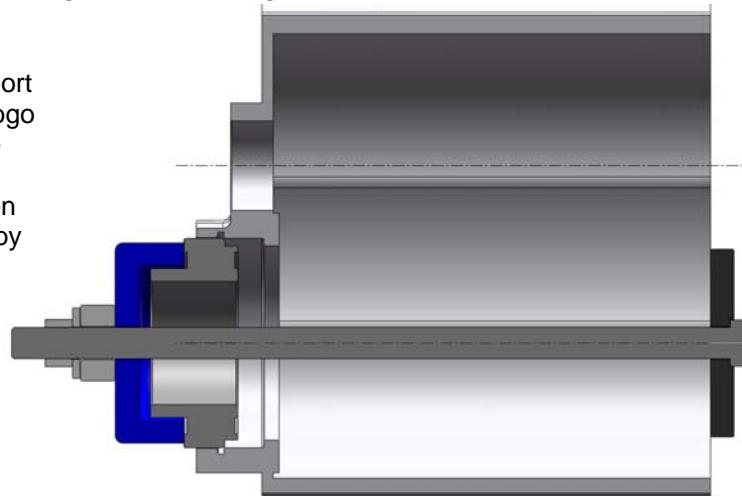

Figure 13

3) Tighten the nut on the draw bar until the bearing is fully seated. **DO NOT OVERTIGHTEN**, the bearing seat/ stop could crack or break off of the case.

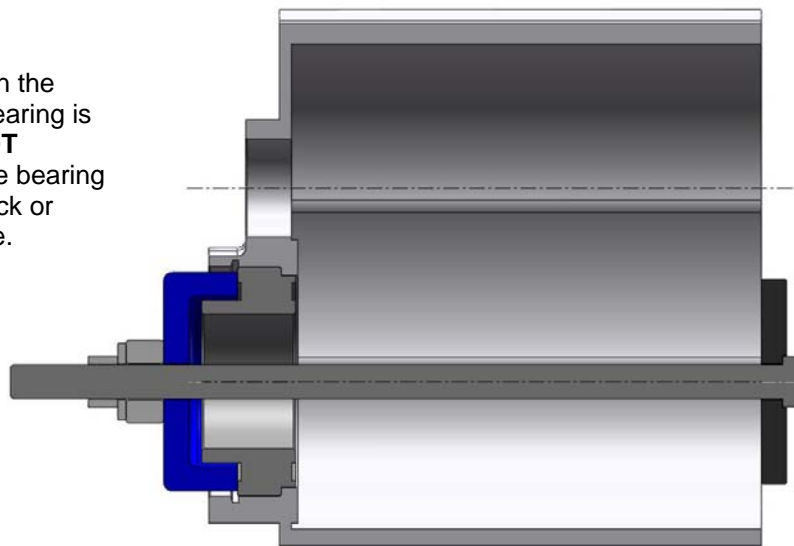

Figure 14

BAKER CD6 MAINDRIVE GEAR & BEARING SERVICE KIT

LIMITED WARRANTY

BAKER™ Inc. transmission assemblies, transmission kits, and wide tire kits are guaranteed to the original purchaser to be free of manufacturing defects in materials and workmanship for a period of 5 years from the date of purchase or up to 50,000 miles - whichever is sooner.

If the product is found by BAKER™ to be defective, such products will, at the option of BAKER™, be replaced or repaired at cost to BAKER™.

In the event warranty service is required, the original purchaser must call or write BAKER™ immediately with the problem. If it is deemed necessary for BAKER™ to make an evaluation to determine whether the transmission assembly or transmission kit is defective, the entire transmission assembly, whether originally purchased as an assembly or kit, must be properly packaged and returned prepaid to BAKER™ with a copy of the original invoice of purchase.

If after an evaluation has been made by BAKER™ and a defect in materials and/or workmanship is found, BAKER™ will, at BAKER™ option, repair or replace the defective part of the assembly.

Warranty card must be returned within 45 days of purchase to be valid.

ADDITIONAL WARRANTY PROVISIONS

This limited warranty does not cover labor or other costs or expenses incidental to the repair and or replacement of BAKER™ products. This warranty does not apply if one or more of the following situations is judged by BAKER™ to be relevant: improper installation, accident, modification (including but not limited to use of unauthorized parts), racing, high performance application, mishandling, misapplication, neglect (including but not limited to improper maintenance), or improper repair.

BAKER™ shall not be liable for any consequential or incidental damages arising out of or in connection with a BAKER™ transmission assembly, transmission kit, swingarm, fender, component or part. Consequential damages shall include without limitation, loss of use, income or profit, or losses sustained as the result of injury (including death) to any person or loss of or damage to property.

BAKER™ transmissions, transmission kits, and Wide Tire Kits are designed exclusively for use in Harley-Davidson® motorcycles. BAKER™ shall have no warranty or liability obligation if a BAKER™ part is used in any other application.

If it is determined that a BAKER™ transmission assembly has been disassembled during the warranty period for any reason, this limited warranty will no longer apply.

BAKER CD6 MAINDRIVE GEAR & BEARING SERVICE KIT

DISCLAIMER:

The words Harley, and H-D are registered trademarks and are for reference only. Use of H-D model designations and part numbers are for reference only. BAKER Drivetrain has no association with, and makes no claim against, these words, trademarks, or companies.

It is the sole responsibility of the user to determine the suitability of this product for his or her use, and the user shall assume all legal, personal injury risk and liability and all other as well as all other obligations, duties and risks associated therewith.

