



## C/5 Sport Clutch Lever Part# CRC530

Congratulations on your purchase of an ASV C/5 Sport Streetbike lever. The correct installation of control levers on a sport/street motorcycle is critical. Incorrect installation or the installation of an incorrect part can result in a malfunction of your clutch and / or front brake system. This lever should be installed by a certified mechanic; preferably at your local motorcycle dealer service dept. ASV Inventions, Inc. accepts no liability for malfunctions as a result of incorrect installation or the installation of a part that was not designed specifically for your motorcycle. Please check the list below to confirm that the correct year, make and model of your motorcycle is listed. If the correct year, make and model of your motorcycle is *not* listed below, then this part is *not* the correct part for your motorcycle and must *not* be installed onto your motorcycle.

### ASV C/5 Sport Clutch Lever part number: CRC530 fits only the following Suzuki motorcycles:

Please disregard any dashes or letters after this part number, (ex; CRC530-SK) Any dashes or letters following your part number are for colors and/or length of the lever (Shorty) and do not affect the application of the lever to the bike.

SUZUKI	YEAR	PART#
GSXR 600	(97-05)	CRC530
GSXR 750	(96-05)	CRC530
GSXR 1000	(01-04)	CRC530
TL1000S	(97-01)	CRC530
Katana 600/750	(98-06)	CRC530
DL-650 V-Strom	(04-07)	CRC530
SV-650 / SV-650S	(99-06)	CRC530

If your motorcycle is not on this list, this part # CRC530 is not the correct part for your Motorcycle.

## INSTALLATION INSTRUCTIONS FOR PART # CRC530

**Tools and supplies needed: 1) 10mm wrench or socket, 1) Flat blade screwdriver, 1) 2.5 mm allen wrench.**

**1** To remove your stock lever, use a 10mm wrench or socket to remove the locknut attached to the main pivot bolt that holds the lever. Once the locknut is removed, leave the bolt in the lever / perch until step 3.

**2a)** Turn the cable adjuster until it is all the way in as close to the perch as possible. Align the cable slot on the adjuster with the cable slot on the perch.

**2b)** Pull the cable away from the perch to expose the inner-wire. You will need to pull very hard to do this. (No damage can occur as you will be simple engaging your clutch slightly while doing this) Guide the inner wire through the adjuster and perch. Then remove the cable barrel from the clutch lever to completely detach the cable from your clutch lever.



**See other side for further instructions**

## INSTALLATION INSTRUCTIONS FOR PART # CRC530 (continued from other side)

**3** After you have the cable completely removed from the lever / perch, unscrew the main pivot bolt with the flat blade screwdriver and slide the bolt out of the perch. The lever will now completely detach from the perch.

**4** Before you install your new ASV lever, you **MUST** choose the correct neutral kill switch tab to install. You will find in the package with this lever one plastic bag with three small bags inside of it. (photo 3a) One bag has two long Allen "Tab Bolts". The other two bags have small black aluminum blocks (kill switch tabs) with labels on them. Part# CRC530-T1 is for all SUZUKI GSXR & TL Models that have an external neutral kill switch on the outside of the perch. This tab uses the two allen screws to mount it to the ASV lever (photo 3b) The Other tab Part# CRC530-T2 is for all SUZUKI Katana, DL & SV models that have an internal neutral kill switch inside the perch. This tab does not require any bolts, it just fits into the ASV Lever using the silver dowel pin to hold it into place. (photo 3c) Choose the correct tab for your bike and install it onto the lever as shown in photos 3b & 3c On that tab that uses the two allen bolts, it is recommended that you use locktite or another type of bolt locker to insure these screws do not come loose. Be sure to tighten these screws as tight as you can without stripping them.

**5** Install your ASV lever Following instructions 1, 2, & 3 in reverse to re-attach your lever into the perch and to install your clutch cable into the lever / perch. On Suzuki bikes that use the Katana, DL & SV internal kill switch tab, be sure to align the internal kill switch with the slot in the ASV tab when installing the lever into the perch.

**6** Install the locknut on the main pivot bolt and tighten using both the 10mm and the screwdriver. Do not over tighten the locknut as it can cause binding of the lever and clutch perch. Maximum torque on locknut should be five (5) foot-lbs. or sixty (60) inch-lbs.

**7** Re-Install your clutch cable. Be sure to re-adjust your cable barrel to allow the correct tension on your clutch cable. Also, be

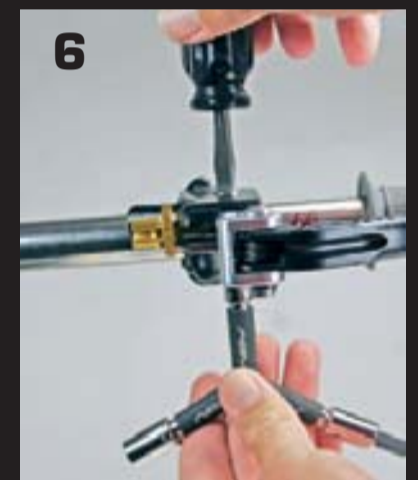

sure to adjust the reach of your new ASV lever so that it fits your hand and engages your clutch properly.

**After installation is complete, with the engine off and bike out of gear, apply the clutch several times to ensure it is functioning properly. There should be no drag or binding when the clutch lever is pulled. Next, With the Key in the "ON" position, your bike in gear, the starter should NOT start your bike. Now, with the clutch pulled in, your bike should start. If your bike does not start while it is in gear unless the clutch lever is pulled in, then your new ASV clutch lever is working correctly. If something does not seem right, consult your mechanic or contact ASV technical support before riding your motorcycle.**

