

## Installation instructions:

# AKRAPOVIC SLIP-ON EXHAUST SYSTEM for the APRILIA SHIVER 750 (2008-2009)

Congratulations on purchasing an Akrapovic exhaust system. Please read these installation instructions carefully. If you have any trouble installing the system please contact your authorized dealer!

### IMPORTANT INFORMATION

#### Exclusion of Certain Liability

- 4 The manufacturer, importer or dealer shall not be liable for any incidental damage including personal injury or any other damages caused by improper installation or operation of the Akrapovic exhaust system. When installing the Akrapovic exhaust system be careful that the exhaust system does not touch other parts sensitive to high temperature.
- 4 Akrapovic makes no representation or warranties with regard to damage caused by the improper installation, use and maintenance of the Akrapovic exhaust system. The warranty is limited to defects recognized by our technical department and to normal use, and excludes items subject to normal wear (gaskets and damping wool). The guarantee is void in case of accident, modification, improper or competition use.
- 4 Do not attempt to install the Akrapovic exhaust system on a motorcycle for which it was not made or tested by Akrapovic.
- 4 When the exhaust system gets very hot during operation, be careful not to burn yourself on the exhaust system or parts which are in direct contact with it, even when the motor is not running. Also protect other people, especially children, from the injuries mentioned above.
- 4 In some cases Akrapovic exhaust system kits contain chemical products (ceramic anti-seizing grease; bolt sealant). Handle with care, do not inhale or swallow. Avoid excessive contact with skin, eyes or mucous membranes. Keep out of reach of children.
- 4 Technical specifications of Akrapovic exhaust systems and related products subject to change without notice.

#### Symbols

The following symbols are used throughout these installation instructions:



**USE BOLT SEALANT;** Apply 3 to 4 small drops of bolt sealant onto the cleaned and degreased threads before tightening bolts. **WARNING! Avoid contact with skin, eyes and mucous membranes. Do not inhale fumes. Keep out of the reach of children.**



**USE ANTI-SEIZING GREASE (white tube);** Prevents seizing, corrosion and excessive wear between the titanium components of your exhaust system. **WARNING! Avoid eye contact. Avoid excessive skin contact. Keep out of the reach of children.**



**USE ANTI-SEIZE LEAD-FREE COPPER PASTE (black tube);** Provides trouble-free and long-lasting protection against seizing, corrosion and rusting of bolts, threaded ends, nuts, joints, etc. Also protects against vibration, wear and impact. **WARNING! Avoid eye contact. Avoid excessive skin contact. Keep out of the reach of children.**

## **INSTALLATION INSTRUCTIONS**

 **BEFORE INSTALLING CHECK SCHEMATIC OF THE EXHAUST SYSTEM!**

**!** IF ANY ITEMS IN THE AKRAPOVIC EXHAUST SYSTEM PACKAGE ARE MISSING PLEASE CONTACT YOUR AUTHORIZED DEALER. KEEP THE SCHEMATIC FOR FUTURE REFERENCE.

**!** THESE INSTALLATION INSTRUCTIONS MUST BE READ CAREFULLY IN ORDER TO ENSURE PROPER INSTALLATION AND OPERATION OF THE AKRAPOVIC EXHAUST SYSTEM.

**!** THE EXHAUST SYSTEM CAN BE EXTREMELY HOT. ALLOW THE MOTORCYCLE TO COOL DOWN BEFORE BEGINNING INSTALLATION.

 **WE ADVISE YOU TO LEAVE INSTALLATION TO A QUALIFIED SERVICEMAN. IMPROPER INSTALLATION MAY RESULT IN A SHORTER LIFETIME OF THE EXHAUST SYSTEM AND/OR DAMAGE TO THE MOTORCYCLE.**



T-handle 10mm wrench  
T-handle 12mm wrench  
T-handle 13mm swiveling wrench  
T-handle 2,5mm three hexagon key wrench  
T-handle 3mm three hexagon key wrench  
T-handle 4mm three hexagon key wrench  
T-handle 5mm three hexagon key wrench  
Combination 7mm wrench  
Combination 13mm wrench  
Spring puller  
Screwdriver (cross head)  
Cutting pliers

### **REMOVAL OF STOCK EXHAUST SYSTEM:**

1. Put the motorcycle on a side stand, we recommend a racing stand. Make sure, that surface is solid and flat.
2. Remove rider's seat and electric cover (**Figure 1, 2, 3, 4**).



Figure 1



Figure 2



Figure 3



Figure 4

3. Unscrew the bolts, pinch off the plastic tie, disconnect the electrical connectors for the rear lights and remove the passenger handles (Figure 5, 6, 7, 8, 9, 10).



Figure 5



Figure 6



Figure 7



Figure 8



Figure 9



Figure 10

4. Unscrew the bolts **A** and remove the license plate bracket with signal lamps and the rear light (Figure 11, 12, 13, 14, 15).

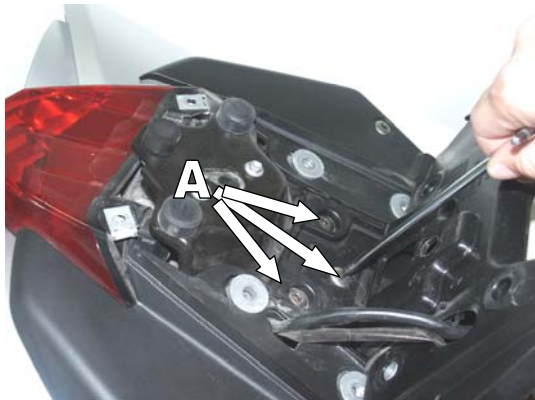

Figure 11



Figure 12



Figure 13



Figure 14



Figure 15

5. Unscrew the bolts and remove the heat shields from stock muffler (Figure 16, 17).



Figure 16



Figure 17

6. Untighten the bolt of the metal clamp at the muffler-link pipe joint (Figure 18). Unscrew and remove the bolts from the muffler bracket and remove the stock muffler with slight rotation (Figure 19, 20). **WARNING! support the muffler with your hand during this procedure or it may fall off and damage you or the motorcycle!** Remove two press-on nuts A (Figure 21).



Figure 18



Figure 19



Figure 20

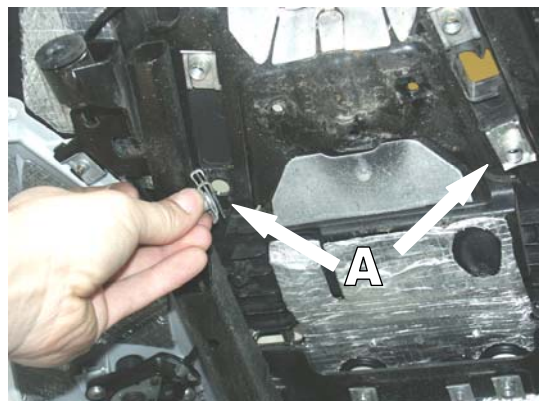

Figure 21

**INSTALLATION OF THE AKRAPOVIC SLIP-ON EXHAUST SYSTEM:**

1. Reattach the license plate holder with signal lamps, tail lamp and the passenger handlebars (Figure 22, 23, 24, 25, 26, 27, 28).



Figure 22

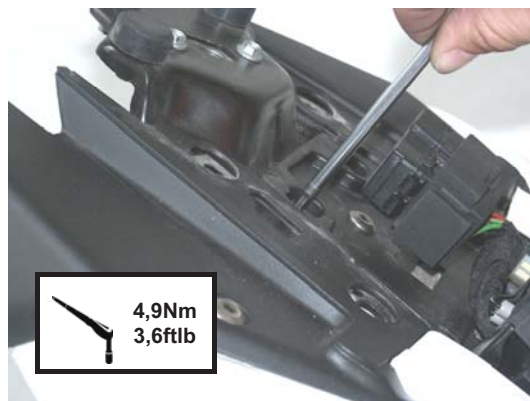

Figure 23



Figure 24

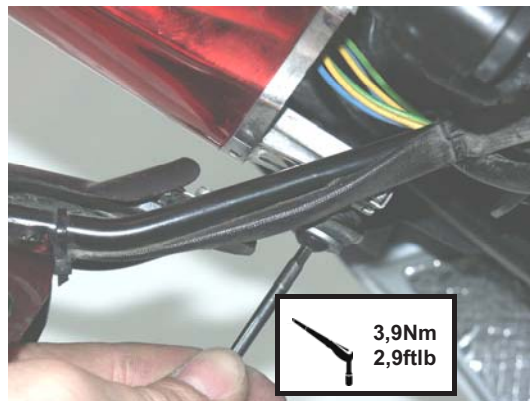

Figure 25



Figure 26

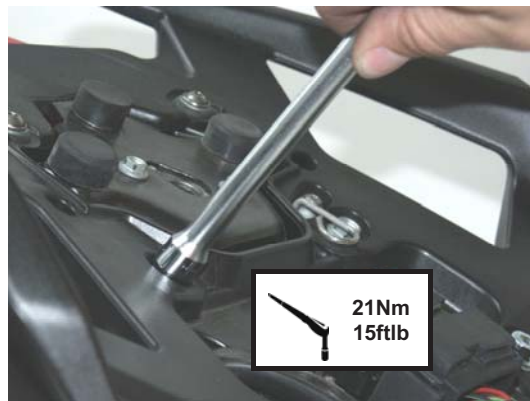

Figure 27

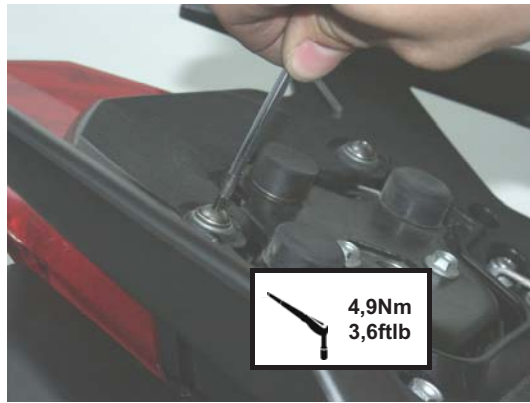

Figure 28

2. Connect the electrical leads connectors and tie up the electrical cables with plastic ties (Figure 29, 30, 31).



Figure 29



Figure 30



Figure 31

3. Install additional Akrapovic muffler bracket and tighten the bolts (Figure 32, 33, 34, 35, 36, 37, 38).



Figure 32



Figure 33



Figure 34



Figure 35



Figure 36



Figure 37



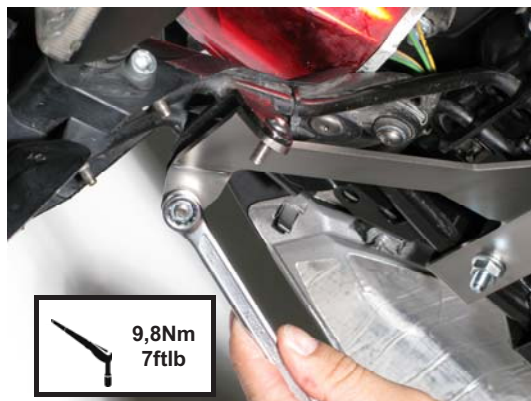

Figure 38

4. **For optional mudguard only:** unscrew the bolts and remove the press-on nuts. Assemble additional Akrapovic muffler bracket and optional mudguard and tighten the bolts (Figure 39, 40, 41, 42, 43, 44, 45).

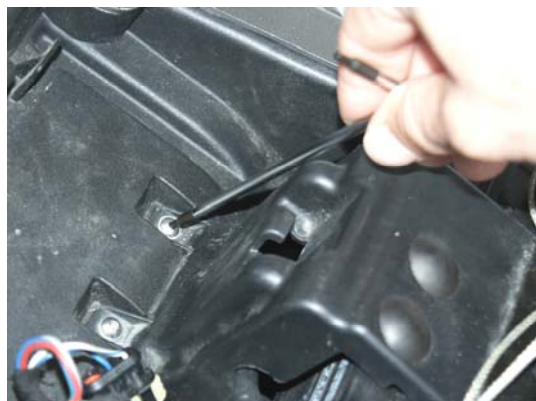

Figure 39



Figure 40



Figure 41



Figure 42



Figure 43



Figure 44

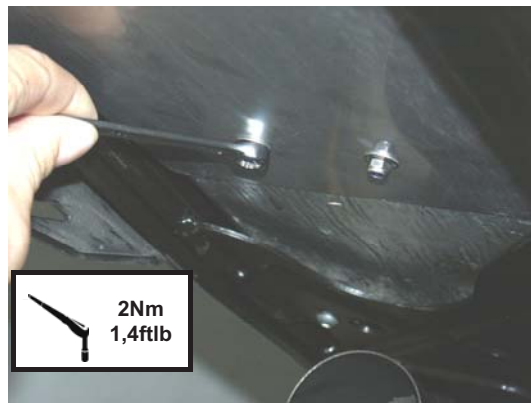

Figure 45

5. Install graphite sleeve gasket into the link pipe. Coat the bolt and interior of metal clamp with Akrapovic anti-seize lead-free copper paste (black tube) and correctly install the metal clamp onto the link pipe (Figure 46, 47).



Figure 46



Figure 47

6. Slide the link pipe onto the stock collector and hand tighten the bolt of link-pipe clamp (Figure 48, 49).



Figure 48



Figure 49

7. Correctly position the carbon-fiber clamps and slide them onto the mufflers. **WARNING! Make sure, that you put muffler clamps on correctly: LEFT muffler TD36 (Figure 50) ; RIGHT muffler TD12 (Figure 51).**

**WARNING! open the clamps slightly wider than the diameter of the outer sleeves of the mufflers – do not scrape them along the mufflers outer sleeves!**



Figure 50



Figure 51

8. Untighten the bolts of the metal clamps at the collector / header tubes joint for easier centering of the Akrapovic mufflers. (Figure 52, 53).



Figure 52



Figure 53

9. Position the mufflers correctly and slide them onto the outlet side of the link pipes (Figure 54). Position and attach the springs (Figure 55). **WARNING!** make sure, that springs pull the mufflers all the way onto the link pipes – use rubber mallet if necessary to tap the connections into place! Tighten the bolts of the Akrapovic muffler bracket/muffler clamps joints, Akrapovic muffler bracket/sub-frame joint and the metal clamp (Figure 56, 57, 58, 59). Make sure the link pipes or mufflers are not touching the frame and other parts. Make sure that the mufflers are centered with respect to the motorcycle.



Figure 54



Figure 55



Figure 56



Figure 57

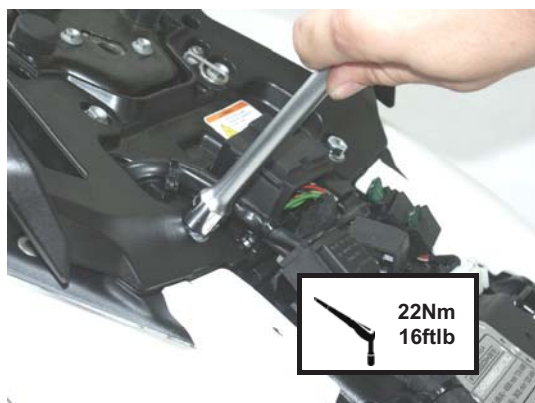

Figure 58

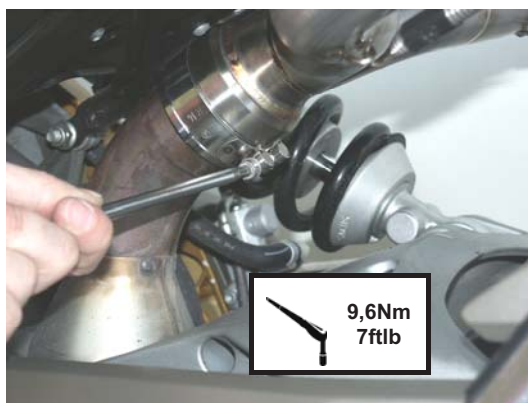

Figure 59

10. Tighten the bolts of the metal clamps at the stock collector/header tube joint. Reattach the electrical cover and rider's seat (Figure 60, 61, 62, 63, 64).

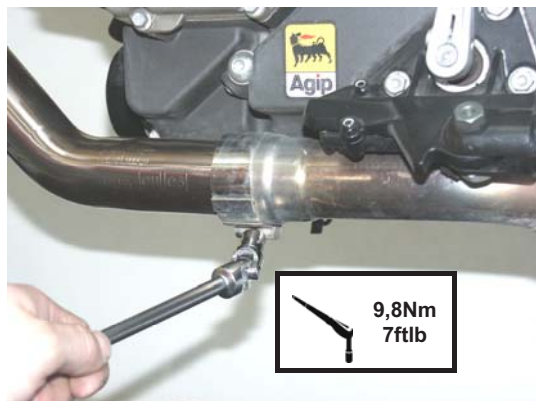

Figure 61

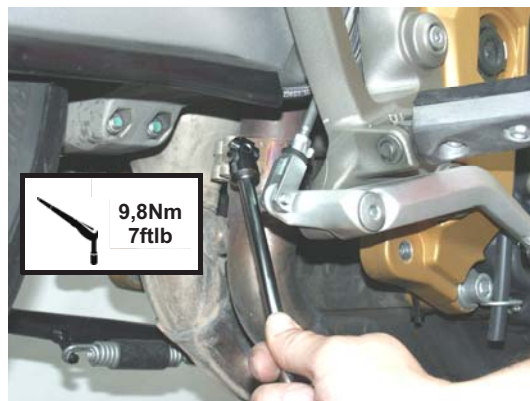

Figure 62



Figure 63

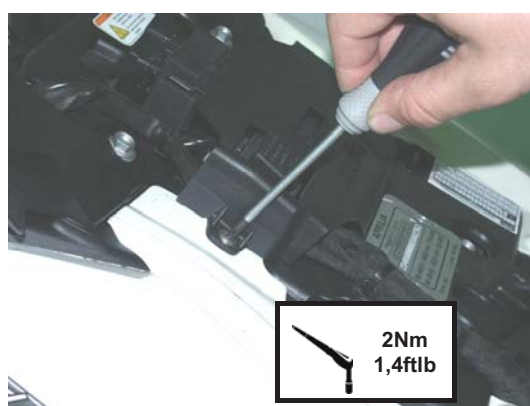

Figure 64



Figure 65

**Final installation:**

1. Clean grease spots:
  - a. Muffler – carbon-fiber outer sleeve: use a soft dry cloth.
  - b. Muffler – titanium outer sleeve: use a soft cloth sprayed with a multi-purpose spray lubricant (WD-40 or equivalent).
  - c. Muffler – carbon-fiber outlet cap: use a soft dry cloth.
  - d. Stainless steel link pipe: use a soft cloth sprayed with a contact cleaner, then wipe with a soft dry cloth.Cleaning will prevent spots from burning onto the surface. Do not use aggressive chemical cleaners, because they can damage the sticker.

Position of the correctly installed Akrapovic **SLIP-ON** system (Figure 66).



Figure 66

2. Check the operation of the brakes and suspension. Make sure all the bolts are sufficiently tightened. In case the exhaust system touches the cowling or other parts repeat the adjustment of the exhaust system or contact your authorized dealer.

**! IT IS NORMAL IF WHITE SMOKE COMES OUT OF THE MUFFLER ON FIRST OPERATION.**

**! DO NOT STAND BEHIND THE MUFFLER ON FIRST OPERATION.**

**! DO NOT USE AUTOMOTIVE WHEEL CLEANERS OR ANY CLEANING PRODUCTS WHICH CONTAIN ACIDIC ADDITIVES TO CLEAN AKRAPOVIC EXHAUST SYSTEMS.**

#### **MAINTENANCE OF THE AKRAPOVIC EXHAUST SYSTEM**

1. Clean the titanium exhaust components with a multi-purpose spray lubricant (WD-40 or equivalent), carbon fiber exhaust components with soft and dry cloth and stainless steel components with soft cloth sprayed with contact cleaner, then wipe with soft and dry cloth. Do not use aggressive chemical cleaners, because they can damage the sticker. A change in the color of the exhaust system is normal due to the high temperatures.
2. The wearing out of the muffler silencing material depends on the type of the engine and riding style. Contact your dealer/serviceman if visible changes appear on muffler's outer sleeve or the noise level is increased.
3. Periodically make sure all the bolts and springs are sufficiently tight.

# APRILIA SHIVER, Slip on street legal/Model year: 2008 - 2009

Product code: S-A7SO1-HDT

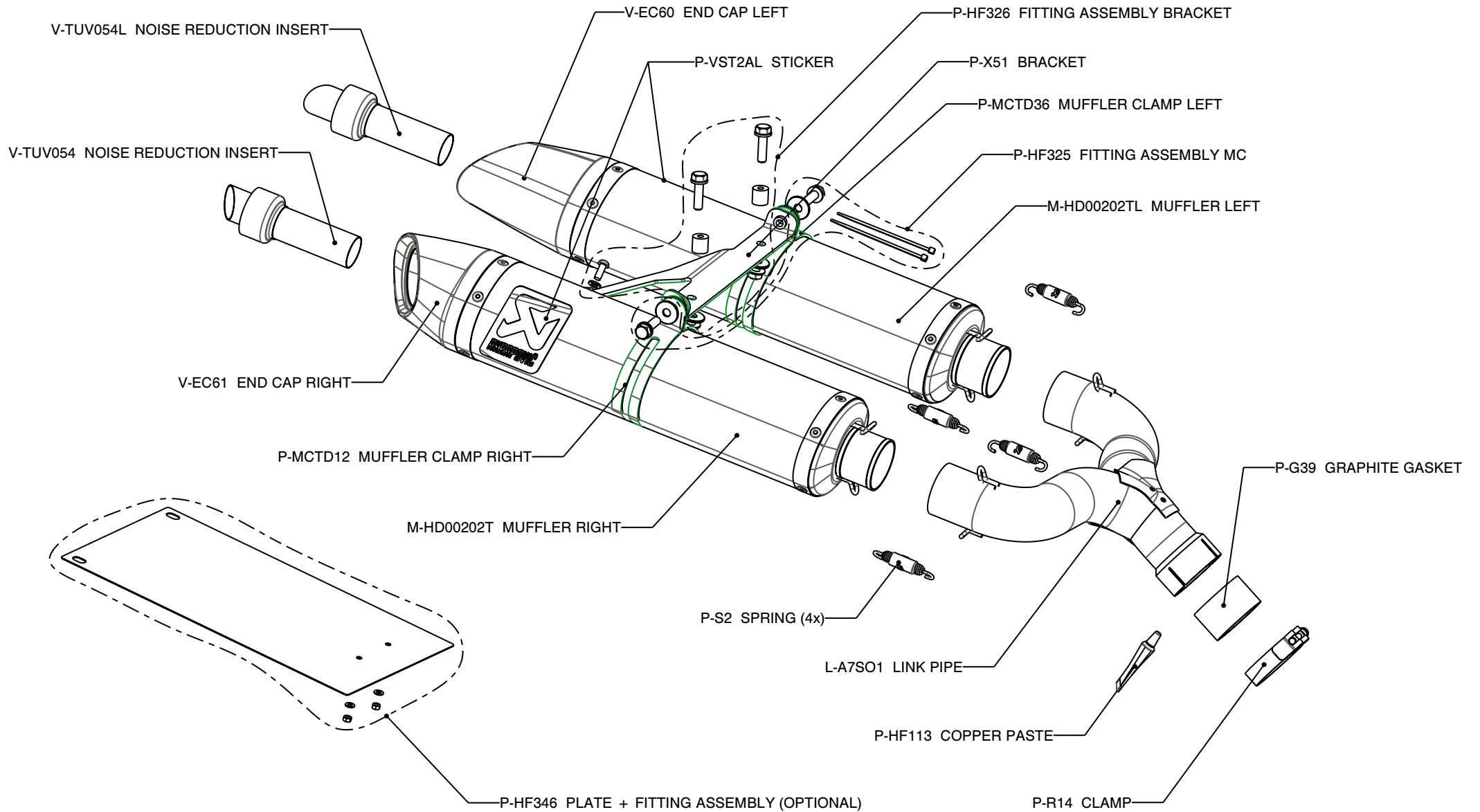

NAV - 389