

Fuel Tank 8.5L YAMAHA

YZ85 1996/2012
0016494

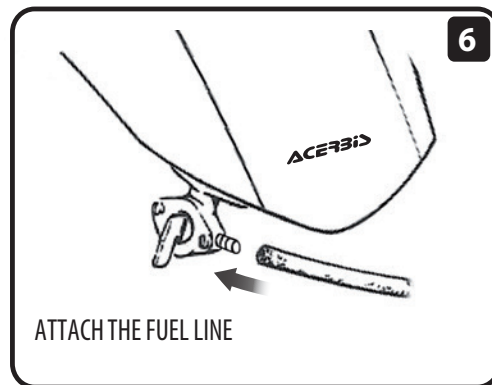
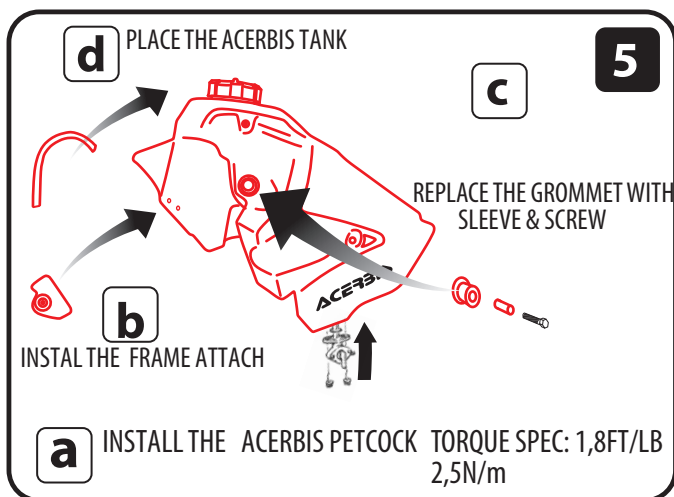
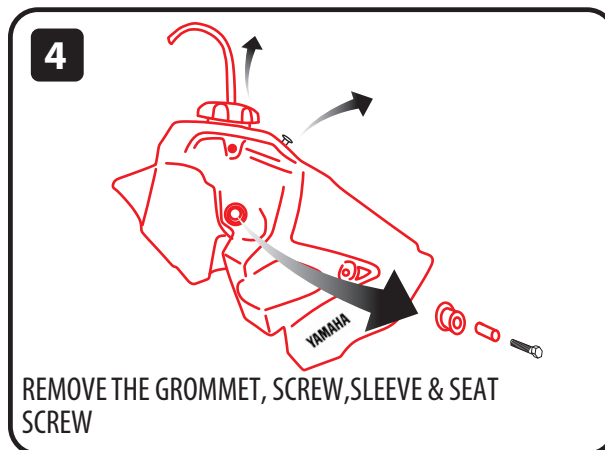
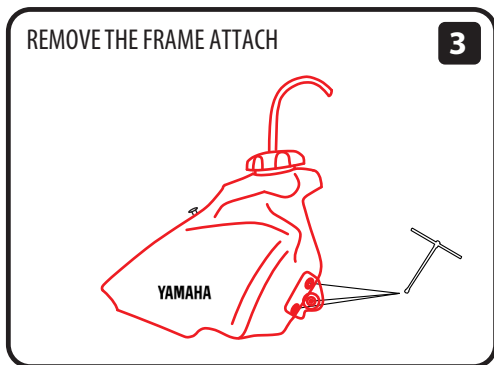
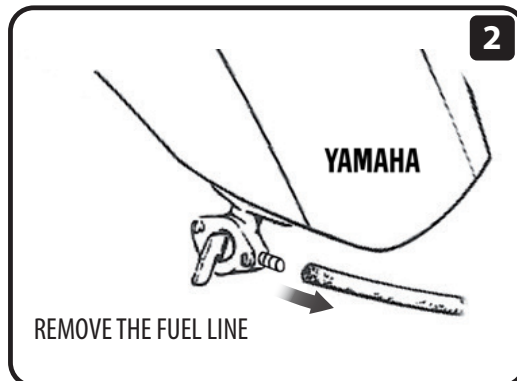
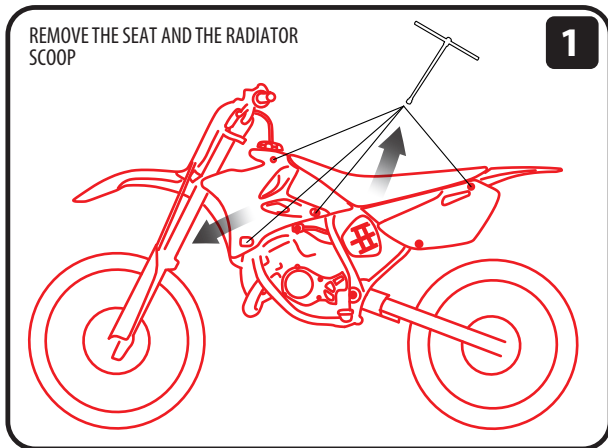

- ACERBIS PARTS LIST**
- N.1 FUEL TANK
 - N.1 GAS CAP
 - N.1 PETCOCK + SCREW
- OEM ITEMS TO USE:**
- FUEL LINE OF: PETCOCK & GAS CUP
 - LEFT MOUNT GROMMET & SLEEVE, RIGHT MOUNT BRACKET ASSEMBLY W/SCREW
 - SEAT HOOK FIXTURE

FOR COMPETITION USE ONLY

DISCLAIMER:
DUE TO UNCONTROLLED VARIABLES IN THE MANUFACTURING PROCESS OF ROTATIONALLY MOLDED FUEL TANKS, THE FUEL TANK MAY VARY IN SIZE AND SHAPE BY UP TO 7% OF THE MANUFACTURER'S ORIGINAL LISTED CAPACITY.

WARNING!
CLEAN TANK INTERIOR THOROUGHLY BEFORE INSTALLATION. INSTALL THIS FUEL TANK ONLY IN A WELL VENTILATED AREA, AS GASOLINE FUMES ARE EXTREMELY DANGEROUS. DO NOT START OPERATE THE VEICHL E IF THERE ARE ANY FUEL LEAKS! ACERBIS RECOMMENDS THAT INSTALLATION BE DONE BY LICENSED MECHANIC. READ ALL INSTRUCTIONS FIRST BEFORE BEGINNING INSTALLATION.

