

2. Remove the fuel line

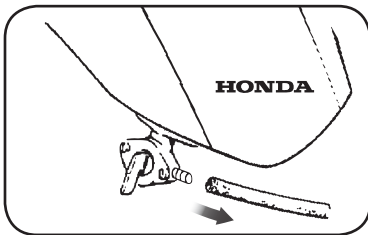

1. Remove the seat and the radiator scoop

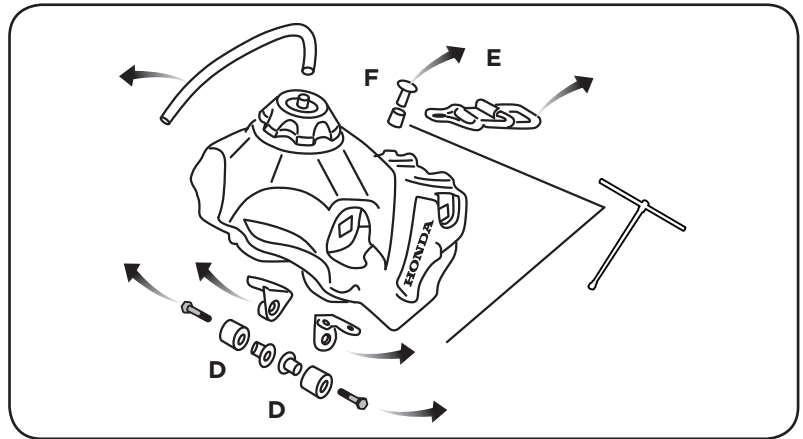
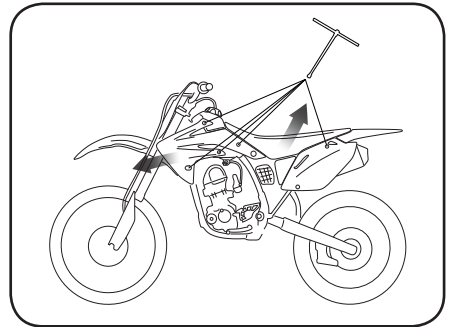

3. Remove the seat screw, elastic attach, frame attach & fuel gas cup line

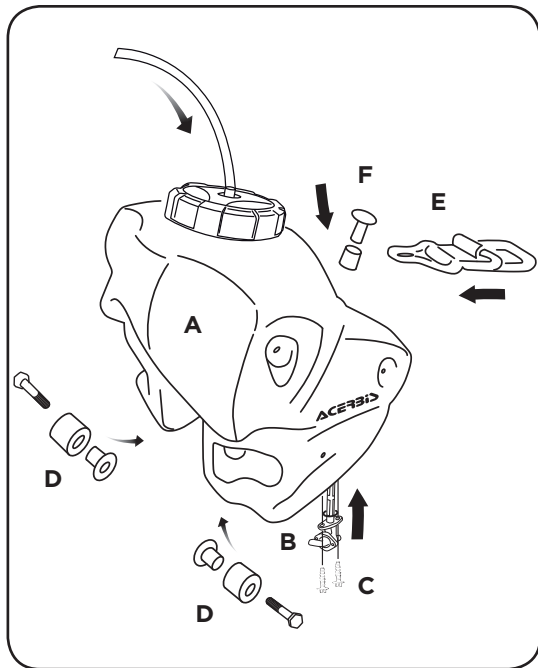

4. (1) Install the acerbis petcock. (2) Place the acerbis tank. (3) Replace the grommets with sleeve. (4) Install the seat screw & elastic attach.

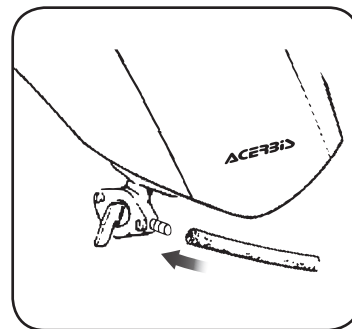

5. Remove the fuel line

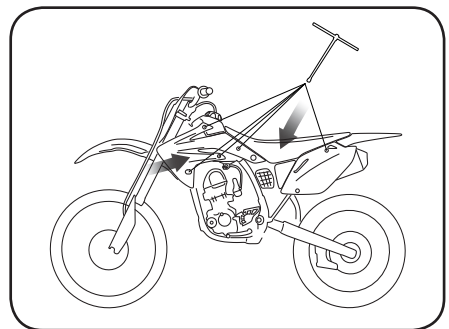

1. Remove the seat and the radiator scoop

WARNING!

Clean tank interior thoroughly before installation. install this fuel tank only in a well ventilated area, as gasoline fumes are extremely dangerous. do not start operate the vehicle if there are any fuel leaks! acerbis recommends that installation be done by licensed mechanic. read all instructions first before beginning installation.