

COD. 5000002581 REV6

**ACERBIS PARTS**

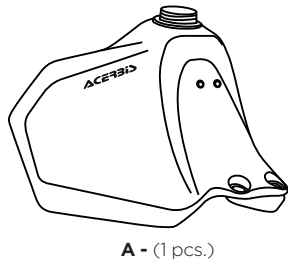

A - (1 pcs.)



B - (1 pcs.)



C - (1 pcs.)



E - (2 pcs.)



F - (2 pcs.)



G - M6X10  
(2 pcs.)



H - M6x30  
(2 pcs.)



I - (2 pcs.)



L - (1 pcs.)



M - (2 pcs.)



N - (1 pcs.)

**O.E.M ITEMS  
TO USE:**



D - (1 pcs.)

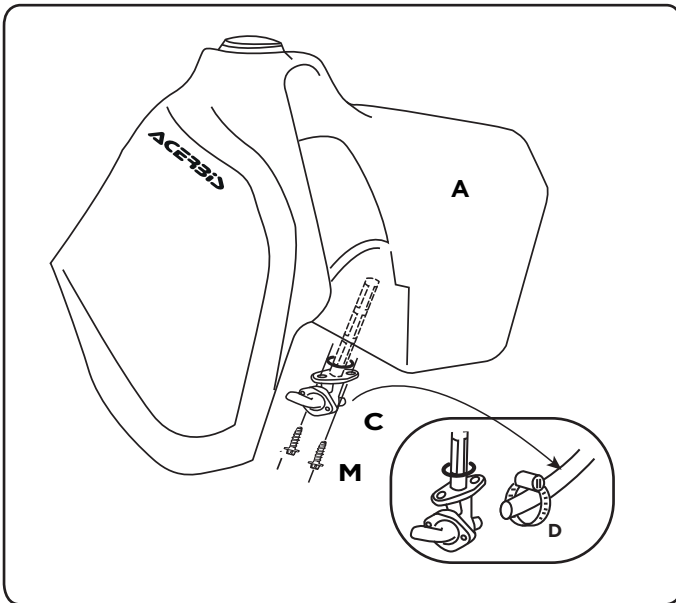

**1. Assemble the Petcocks C (including O-Ring) using the appropriate screws M.**

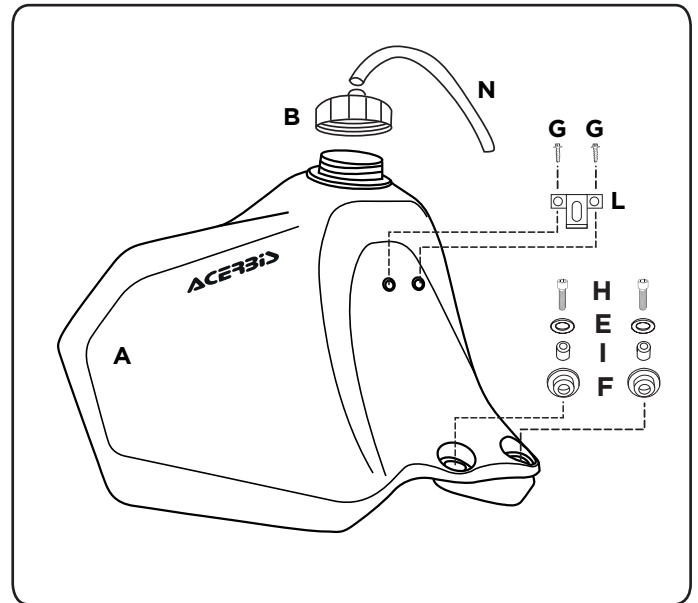

**2. Insert the tube N in the cap B. Fix the bracket L using screws G, and fix the tank on frame using the parts F-I-E-H.**

**WARNING!**

Clean tank interior thoroughly before installation. install this fuel tank only in a well ventilated area, as gasoline fumes are extremely dangerous. do not start operate the vehicle if there are any fuel leaks! acerbis recommends that installation be done by licensed mechanic. read all instructions first before beginning installation.

**DISCLAIMER:**

DISCLAIMER: Due to uncontrolled variables in the manufacturing process of rotationally molded fuel tanks, the fuel tank may vary in size and shape by up 7% of the manufacturer's original listed capacity.