

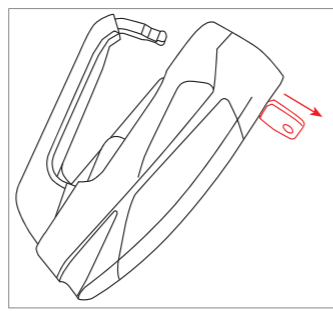

ABUS Detecto
7000 RS1

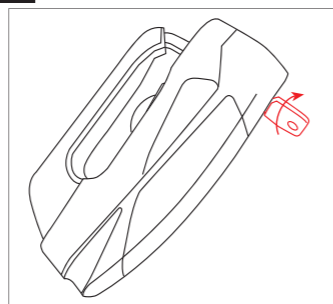

1



2

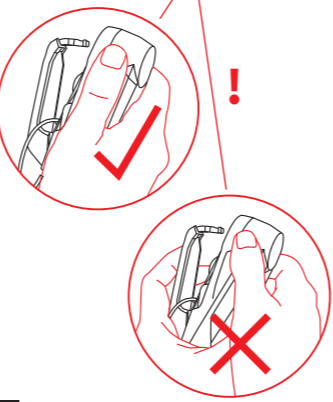
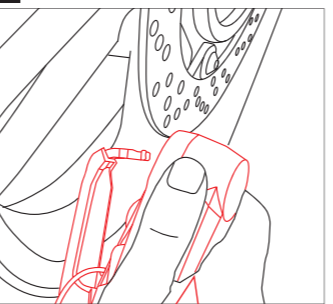

3

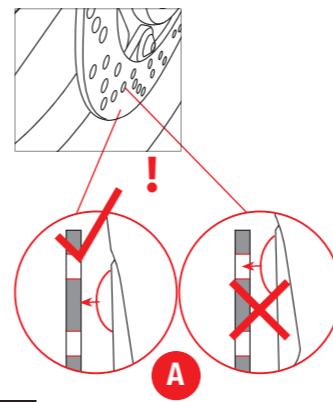

4

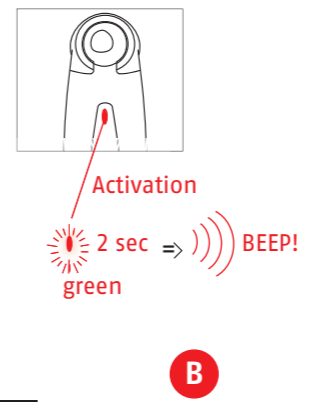
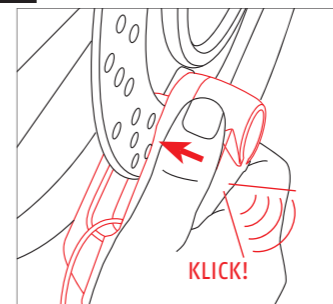

5

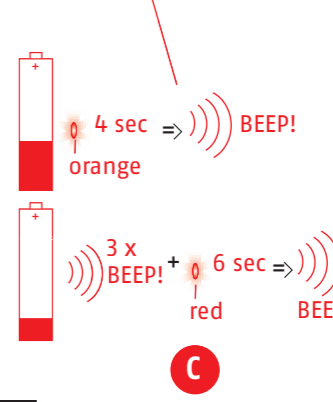
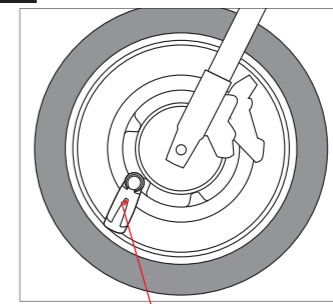

6

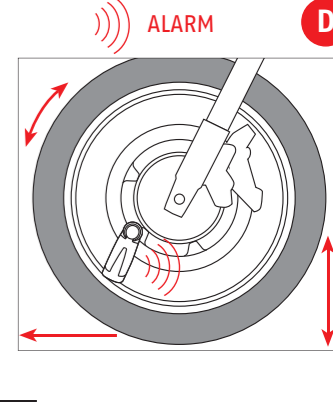
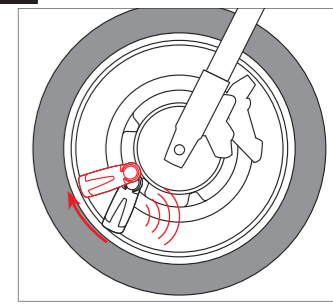

7

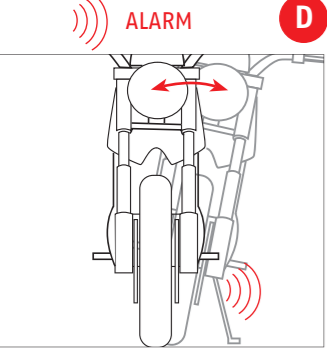
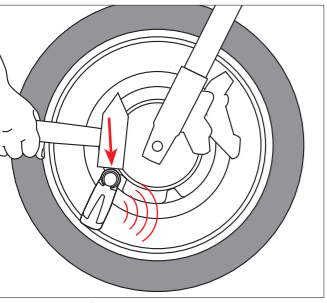

8

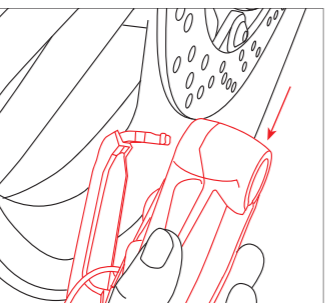
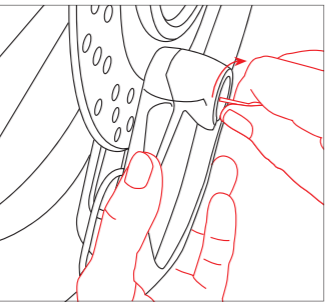

9

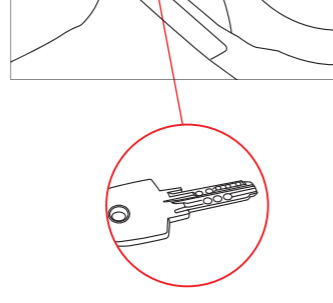
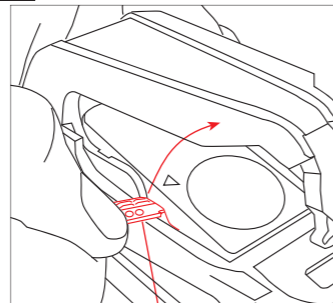

10

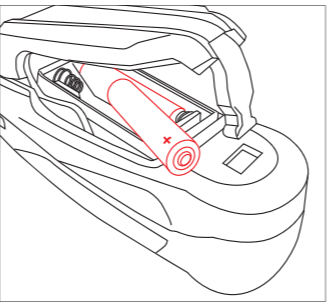
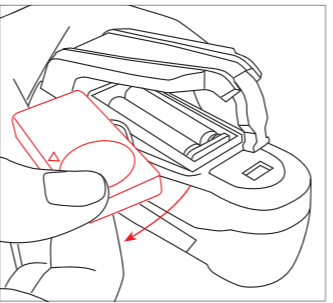

11

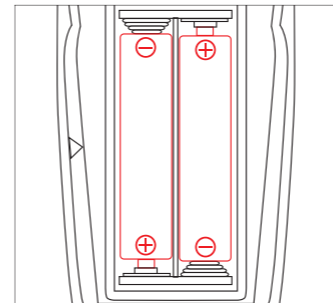

12

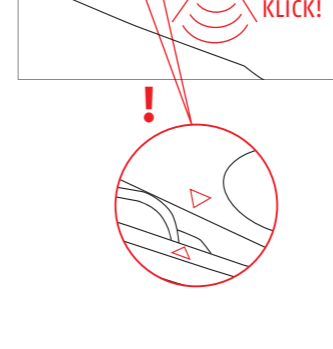
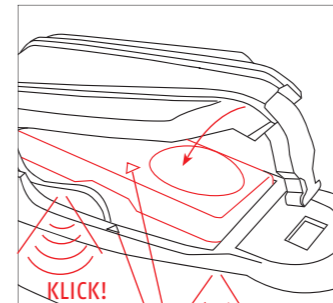

13

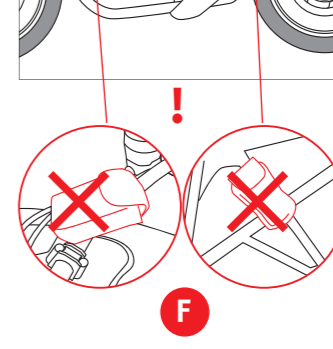
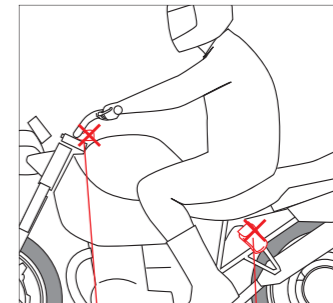

14

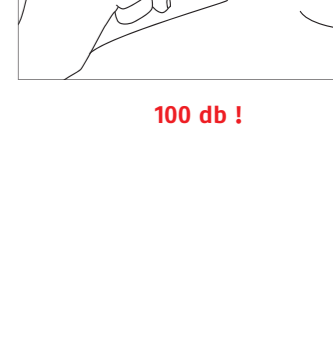
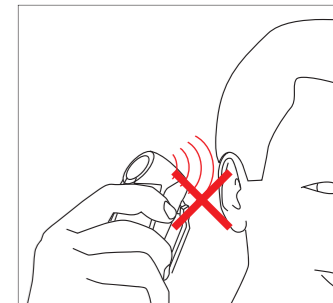

100 db !

- A** Grab the top part of the lock with one hand, push onto the brake disk, guide the bolt through an opening and push the arched battery compartment against the disk. The lock latches and is automatically activated (see Fig. 3-5).
- B** Arming is indicated with an LED that shines for 2 sec. (green) and a subsequent beep. Repeated flashing every 6 sec. (red) signals activation.
- C** Low battery warning (2,6-2,9V): rapid flickering of the orange LED. Arming is indicated after 4 sec. by a beep. The alarm function is completely enabled, but batteries should be replaced soon. (<2,6V): Rapid flickering of the red LED and 3 short "beep" tones. Arming is indicated after 6 sec. by a beep. The alarm function can not be guaranteed to full extend. Batteries should be replaced as soon as possible.
- D** The alarm is activated by any movement or shock of lock (3D-Position System; pic 6.7). The alarm is automatically deactivated after approx. 15sec. and the detection system reactivates itself again.
- E** We recommend using high-quality alkaline batteries. Pay attention to correct polarity (+/-) when inserting.
- F** Safety instructions: Do not transport the lock externally on the motorcycle while riding (accident hazard).

Note: Do not short-circuit the batteries; do not throw them into fire and do not charge.

Batteries may be returned after use.



B



C E

ABUS is not liable to damages or inquiries caused by inappropriate mounting. Any legal rights remain unaffected. Subject to technical modifications.

Find out more about motorcycle locks we have.